

POE-EXT02G

Mini 2-Port Gigabit PoE Extender to Split One PoE cable for Two PoE devices



Outstanding Features

- **1-IN-2-Out POE EXTENDER:** Split 1 PoE input to 2 PoE Outputs to power two IP Cameras through existing network cable.
- **UP TO 330ft POE EXTENSION:** Boost and extend PoE + Data signal by extra 330ft over regular Cat5E or Cat6 network cable.
- **Excellent Stability:** Upgraded from popular PoE-Extender02, adopts metal casing with enhanced heat dissipation
- **GREAT COMPATIBILITY:** Compliant with IEEE 802.3af/at PoE Standards, works well with PoE Switches, PoE Injectors or PoE NVRs.
- **Gigabit High Speed:** Provide reliable high speed of 1000Mbps to keep your devices running smoothly
- **Compact Design:** Mini size with 82.7 × 25.8 × 53.6 mm (3.26 × 1.02 × 2.11 in), fit into wall-mount bracket, junction box and other outdoor waterproof enclosures.
- **PLUG-N-PLAY:** Easily plug in the ethernet ports with no configuration.
- **INDUSTRIAL DESIGN:** For harsh environment, with IP53 metal enclosure, wide working temperature from -22 °F to +149 °F (-30 °C to 65 °C) , DIN-rail mounting, 4kV surge

Specification

Hardware	
Dimensions (W*H*D)	82.7 × 25.8 × 53.6 mm (3.26 × 1.02 × 2.11 in)
Weight	107g (0.2 lb)
Material	Metal
Installation	Din Rail Mount
Interfaces	
Network	PoE in: 1 * 10/100/1000 Mbps RJ45 PoE Port PoE Out: 2 * 10/100/1000 Mbps RJ45 PoE Ports
Transmission	
Distance	Each PoE Extender will extend Extra 330ft PoE+ Data transmission
Cascade deployment	Support two levels cascade deployment
PoE	
PoE In	PoE+, IEEE 802.3af/at Support both Mode A (Pins 1/2 [+], 3/6 [-]) and Mode B (Pins 4/5 [+], 7/8 [-])
PoE Out	Two PoE Output Ports (48V), up to 30W on one port, 30W total shared power budget Pins 4/5 [+], 7/8 [-].
Device Power Consumption	<=3W
Total PoE Budget	<=30W
LED Indicators	
PWR	Power
PoE	Power over Ethernet
L/A	Link/Activity
Environment	
Operating Temperature	-30°C to 65°C (-22°F to 149°F)
Operating Humidity	10% to 90% non-condensing
ESD/Surge Protection	4KV

**Disclaimer: Technical specifications may subject to change without prior notice*

Interface

Front View

Gigabit IEEE 802.3af/at PoE
Input Port, Max. 30W

Two Gigabit PoE Output Ports,
Max. 30W

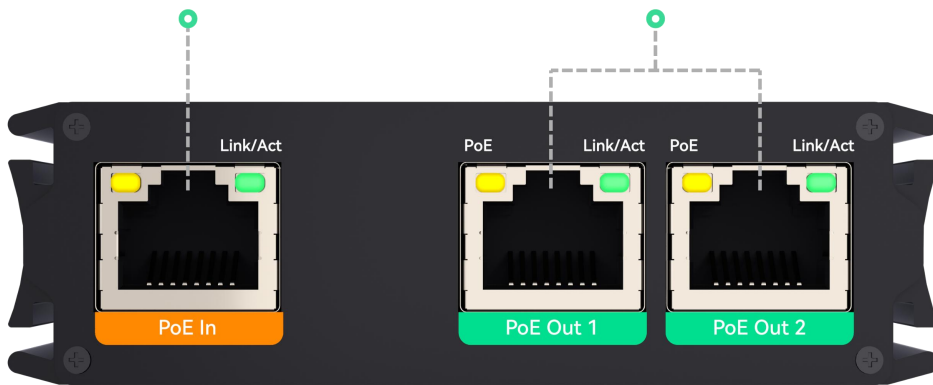

Total PoE Budget is 30W

Rear View

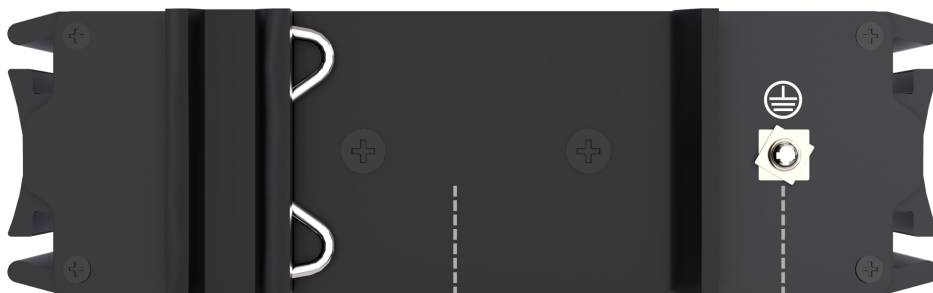

DIN Rail

Grounding Terminal

**Disclaimer: Technical specifications may subject to change without prior notice*

Dimension

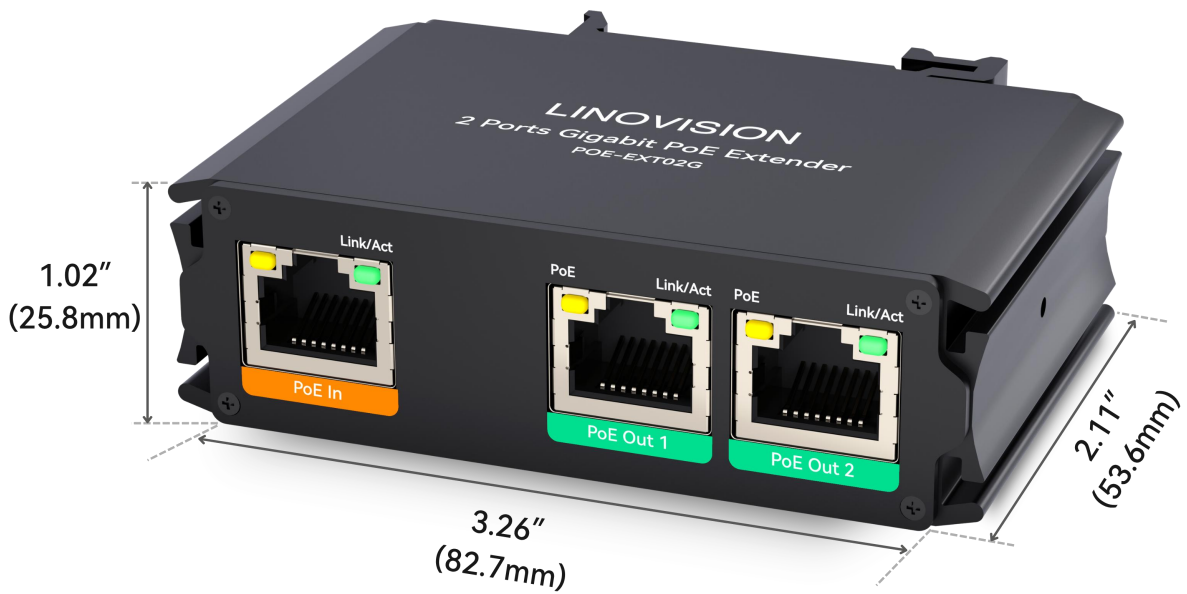

Weight: 107g (0.2 lb)

Installation

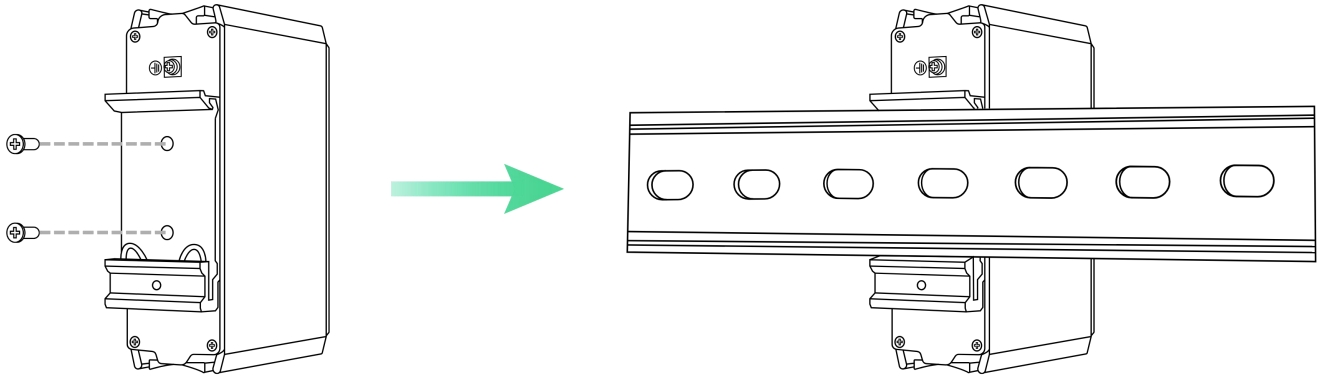

DIN-rail Installation

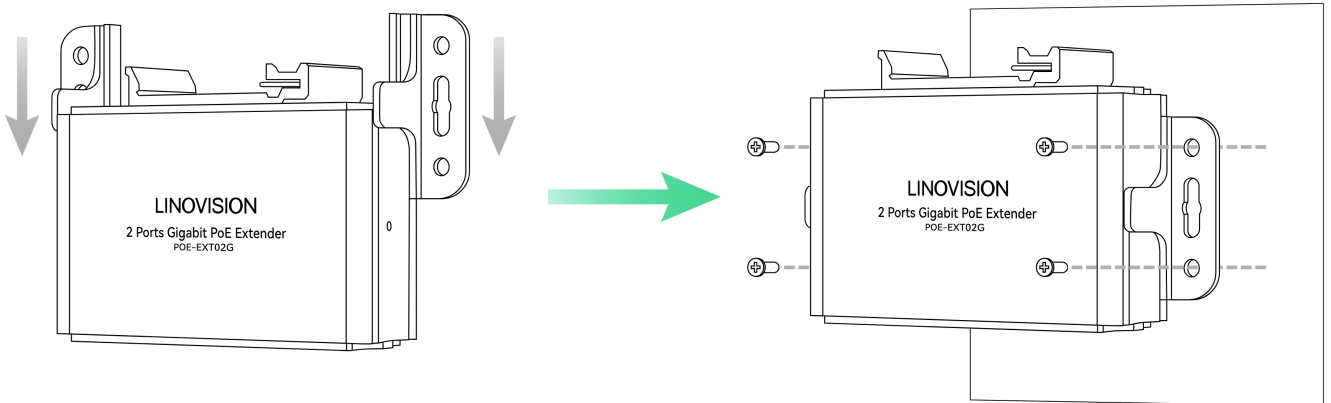

Wall-mounting Installation

Connection Diagram

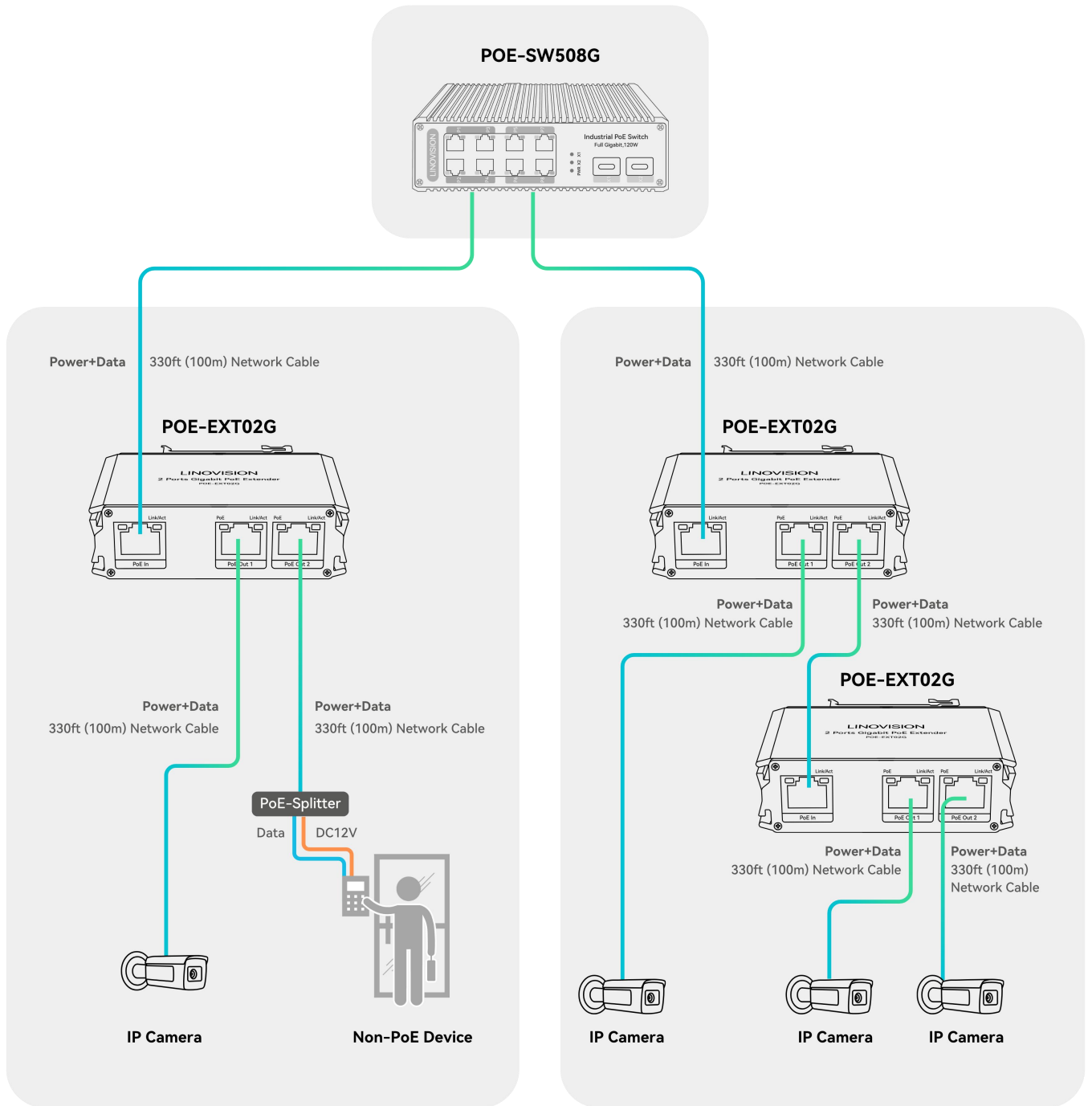

Surveillance System

Cascade Deployment

Package Contents



POE-EXT02G



DIN-Rail Mounting Accessory



Wall Mounting Accessory



User Manual