

## POE-EXT02G

Mini 2-Port Gigabit PoE Extender to Split One PoE cable for Two PoE devices



### Outstanding Features

- **1-IN-2-Out POE EXTENDER:** Split 1 PoE input to 2 PoE Outputs to power two IP Cameras through existing network cable.
- **UP TO 330ft POE EXTENSION:** Boost and extend PoE + Data signal by extra 330ft over regular Cat5E or Cat6 network cable.
- **Excellent Stability:** Upgraded from popular PoE-Extender02, adopts metal casing with enhanced heat dissipation
- **GREAT COMPATIBILITY:** Compliant with IEEE 802.3af/at PoE Standards, works well with PoE Switches, PoE Injectors or PoE NVRs.
- **Gigabit High Speed:** Provide reliable high speed of 1000Mbps to keep your devices running smoothly
- **Compact Design:** Mini size with 82.7 × 25.8 × 53.6 mm (3.26 × 1.02 × 2.11 in), fit into wall-mount bracket, junction box and other outdoor waterproof enclosures.
- **PLUG-N-PLAY:** Easily plug in the ethernet ports with no configuration.
- **INDUSTRIAL DESIGN:** For harsh environment, with IP53 metal enclosure, wide working temperature from -22 °F to +149 °F (-30 °C to 65 °C) , DIN-rail mounting, 4kV surge

## Specification

<b>Hardware</b>	
Dimensions (W*H*D)	82.7 × 25.8 × 53.6 mm (3.26 × 1.02 × 2.11 in)
Weight	107g (0.2 lb)
Material	Metal
Installation	Din Rail Mount
<b>Interfaces</b>	
Network	PoE in: 1 * 10/100/1000 Mbps RJ45 PoE Port PoE Out: 2 * 10/100/1000 Mbps RJ45 PoE Ports
<b>Transmission</b>	
Distance	Each PoE Extender will extend Extra 330ft PoE+ Data transmission
Cascade deployment	Support two levels cascade deployment
<b>PoE</b>	
PoE In	PoE+, IEEE 802.3af/at Support both Mode A (Pins 1/2 [+], 3/6 [-]) and Mode B (Pins 4/5 [+], 7/8 [-])
PoE Out	Two PoE Output Ports (48V), up to 30W on one port, 30W total shared power budget Pins 4/5 [+], 7/8 [-].
Device Power Consumption	<=3W
Total PoE Budget	<=30W
<b>LED Indicators</b>	
PWR	Power
PoE	Power over Ethernet
L/A	Link/Activity
<b>Environment</b>	
Operating Temperature	-30°C to 65°C (-22°F to 149°F)
Operating Humidity	10% to 90% non-condensing
ESD/Surge Protection	4KV

*\*Disclaimer: Technical specifications may subject to change without prior notice*

## Interface

### Front View

Gigabit IEEE 802.3af/at PoE  
Input Port, Max. 30W

Two Gigabit PoE Output Ports,  
Max. 30W

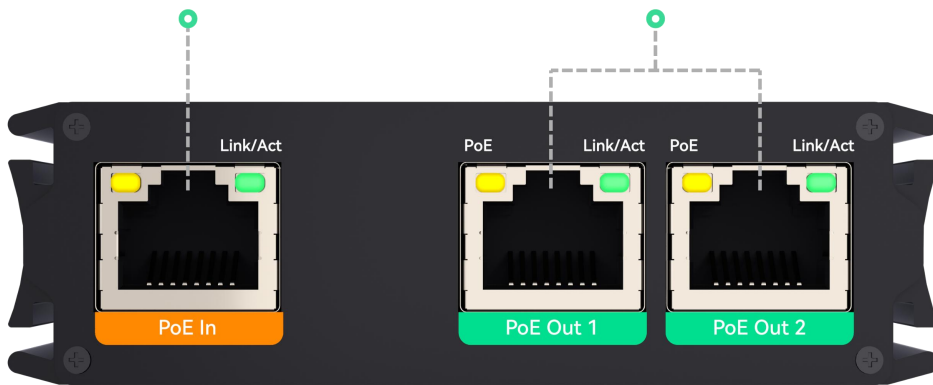

Total PoE Budget is 30W

### Rear View

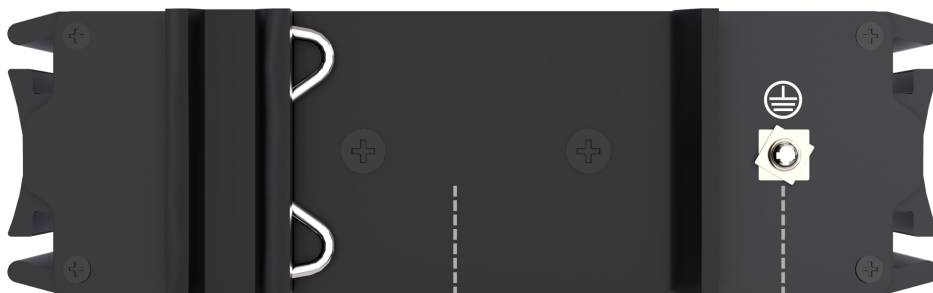

DIN Rail

Grounding Terminal

*\*Disclaimer: Technical specifications may subject to change without prior notice*

## Dimension

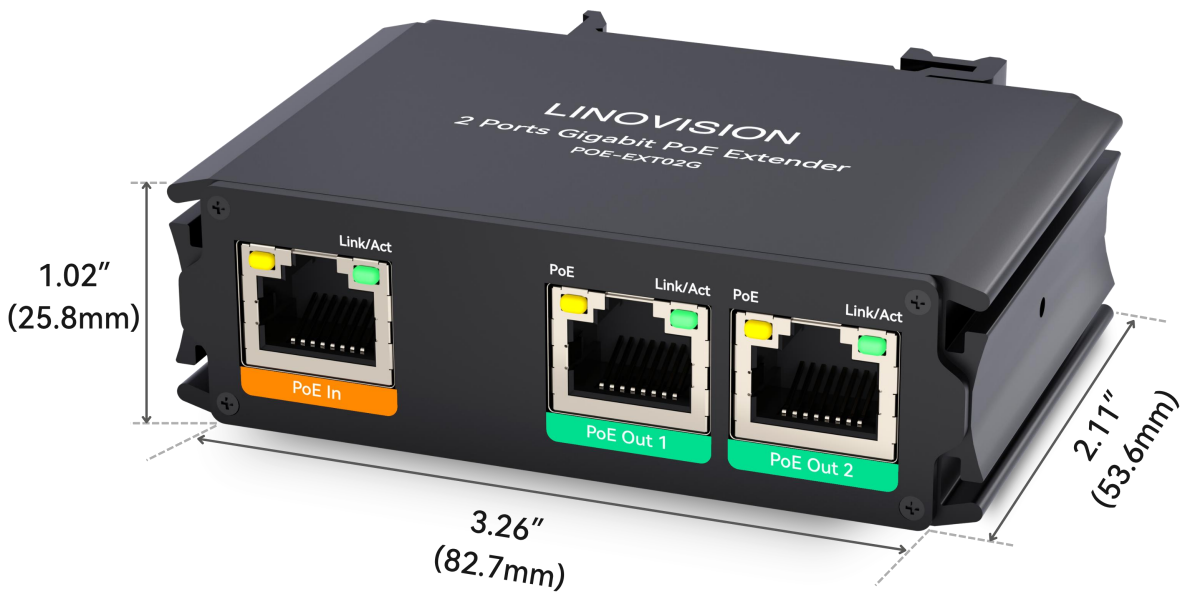

Weight: 107g (0.2 lb)

## Installation

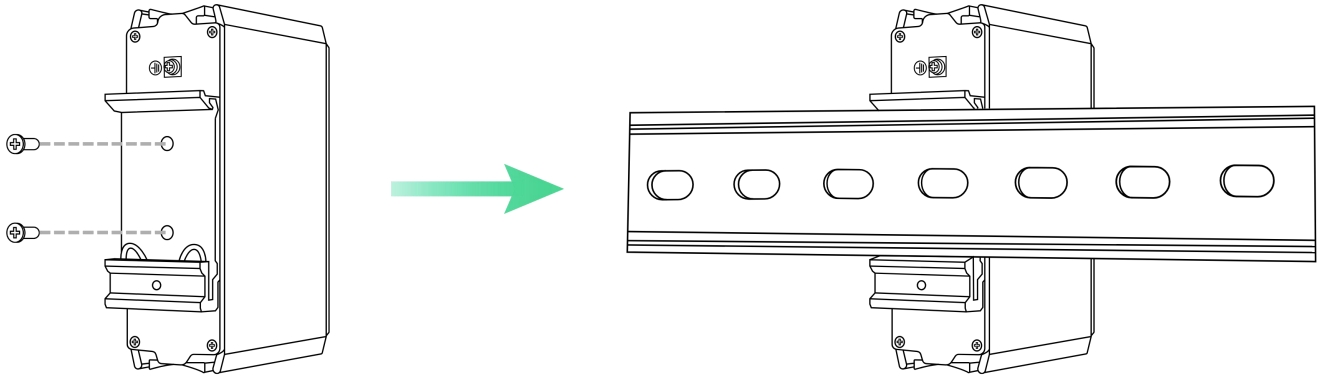

## DIN-rail Installation

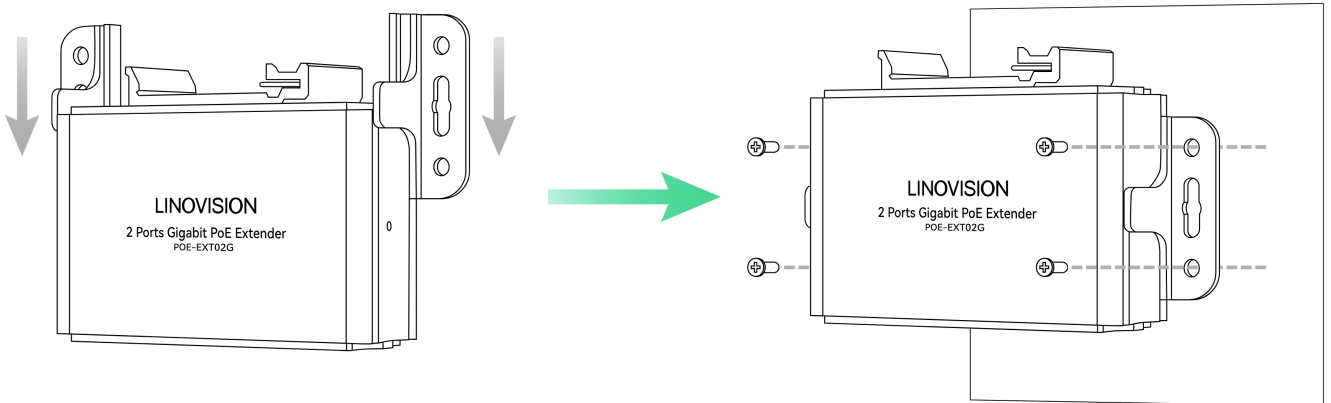

## Wall-mounting Installation

## Connection Diagram

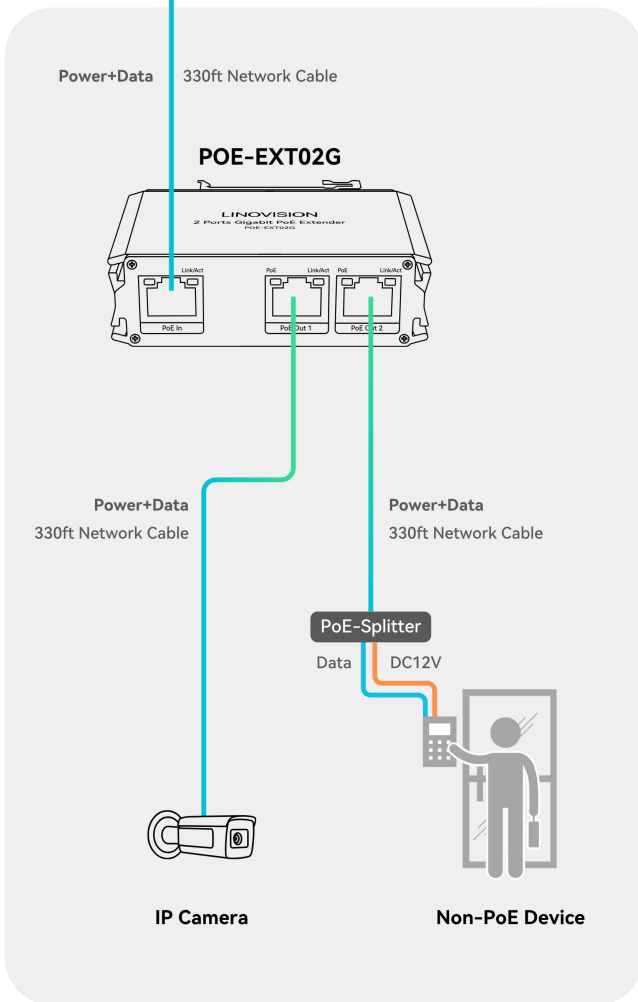
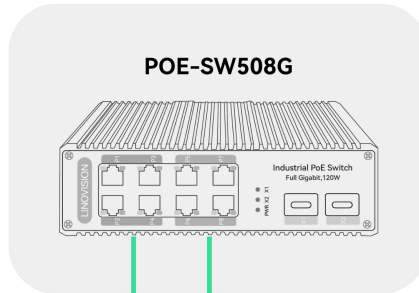

**Surveillance System**

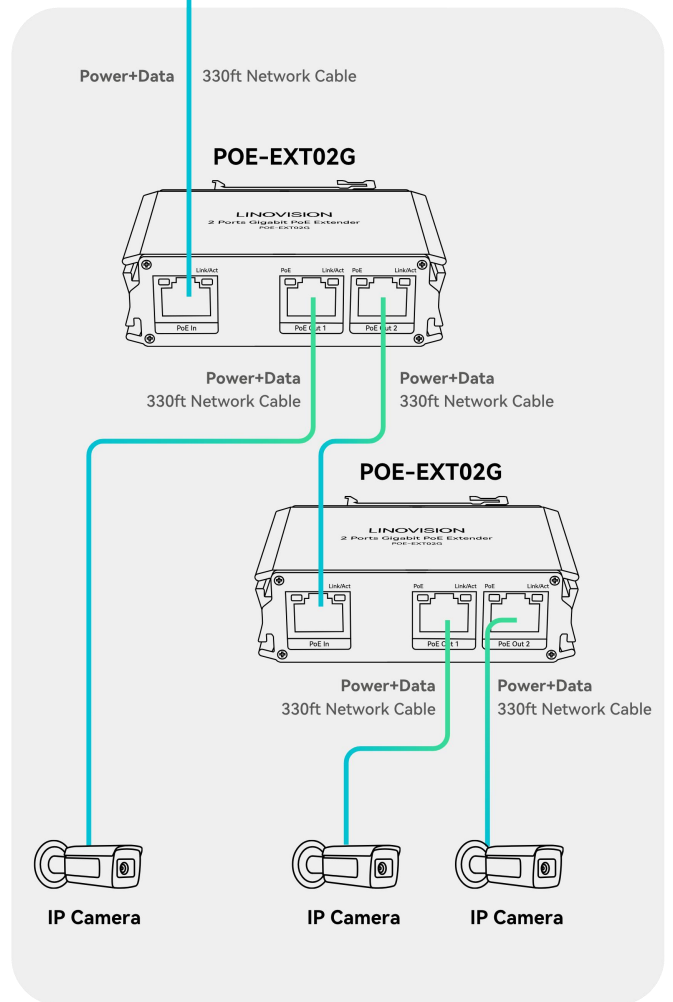

**Cascade Deployment**

## Package Contents



POE-EXT02G



DIN-Rail Mounting Accessory



Wall Mounting Accessory



User Manual