

POE-SP02BT-POE

90W Gigabit PoE Splitter With IEEE802.3bt PoE Output and DC 5/9/12/24V Output



Outstanding Features

- **BT90W PoE SPLITTER** – Split 90W IEEE802.3bt PoE to IEEE802.3bt POE and DC power outputs, max 72W in total.
- **IEEE802.3BT PoE OUTPUT** – 1 x Gigabit IEEE802.3bt PoE output. Active PoE follows PD Detection → Classification Type → Power On procedures to prevent standard PD device from damaging. So Non-PoE devices are also supported.
- **5V/9V/12V/24V DC OUTPUT** – 1 x DC 5V/14A or 9V/7.8A or 12V/5.9A or 24V/3A switchable output (terminal blocks).
- **INTELLIGENT LED INDICATOR** – Shows 5V/9V/12V/24V DC output. Help to efficiently control how much power is output.
- **RUGGED DESIGN** – For harsh environment with wide temperature range between $-40^{\circ}\text{F} \sim 167^{\circ}\text{F}$ ($-40^{\circ}\text{C} \sim 75^{\circ}\text{C}$). Short-circuit protection. Thermal cut. DIN-Rail mount.
- **APPLICATIONS** – Provide a shared 72W power to PoE devices or Non-PoE devices simultaneously, like the outdoor PTZ camera with extra wiper or IR, IP cameras, video server, Wireless AP, LED lighting, VoIP phone, etc.

Specification

POE-SP02BT-POE	
Interface	1 10/100/1000M RJ45 PoE Port (DATA + POWER IN) 1 10/100/1000M RJ45 PoE Port (DATA + POWER OUT) 1 DC interface (DC OUT)
Network Media	10Mbps: Cat 3,4,5 Unshielded Cable 100Mbps: Cat 5,5E Unshielded Cable 1000Mbps: Cat 5E, 6 Unshielded Cable
Pass Through Data Rates	10/100/1000 Mbps
Power Output	Adjustable 5VDC/14A max, 9VDC/7.8A max, 12VDC/5.9A max, 24VDC/3A max, DC
Input Power Requirements	Input Voltage: 44 to 57 Vac
Indicators	PoE Indicators / DC out Voltage Indicators
Connectors	Shielded RJ-45, EIA 568A and 568B
Regulatory Compliance	IEEE 802.3af (PoE) IEEE 802.3at (PoE) IEEE 802.3bt (PoE) IEEE 802.3 (Ethernet) IEEE 802.3u (Fast Ethernet) IEEE 802.3ab (Gigabit Ethernet) RoHS Compliant, CE, FCC
Dimensions (W*H*D)	4.69x3.37x1.10" (119x85.5x28mm)
Environmental Conditions	Operating Ambient Temperature: -40° to 167°F (-40 to 75°C) Operating Humidity: Maximum 90%, Non-condensing Storage Temperature: -40° to 167°F (-40 to 75°C) Storage Humidity: Maximum 95%, Non-condensing
Electromagnetic	FCC Part15, Class B

Interface

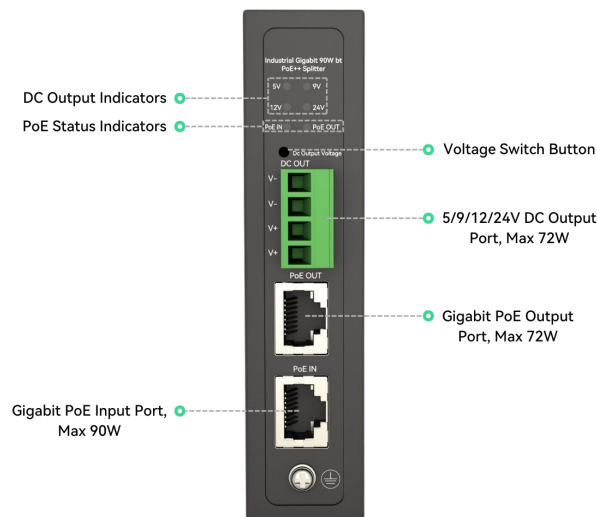

 72W max output for whole devices(DC Output + PoE Output)

Dimension



Weight:0.4kg (0.9 lb)

Installation

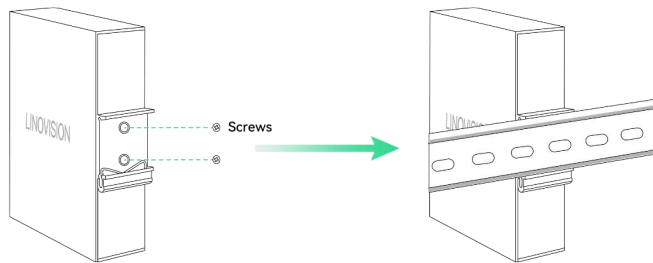

DIN-Rail Mounting

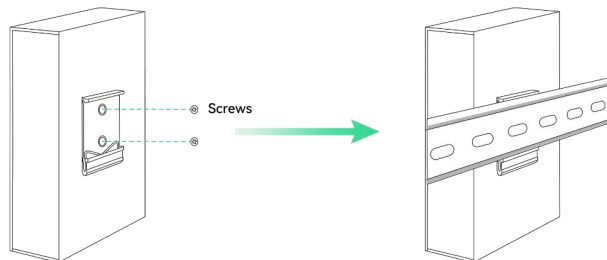

Disclaimer: Technical specifications may subject to change without prior notice.

Package included



POE-SP02BT-POE



Terminal



DIN-Rail
Mounting Accessory



User Manual