

POE-SP02BT-POE

90W Gigabit PoE Splitter With PoE Output



PoE-SP02BT-POE splits 48VDC into 5V/9V/12V/24VDC power outputs via RJ45 Ethernet cable. Support for PoE applications in Gigabit Ethernet environments. Complies with IEEE 802.3af/at/bt power classification and supports conversion to DC output and PoE direct output. BT has a maximum output power of 72W.

Outstanding Features

- Complies with IEEE802.3af, IEEE802.3at, IEEE802.3bt.
- Support PoE applications in Gigabit Ethernet environments.
- Support wide input voltage range 44Vdc to 57Vdc.
- Maximum power output up to 72W.
- Support for the POE output of IEEE 802.3af/at/bt.
- Adjustable output 5VDC/14A or 9VDC/7.8A or 12VDC/5.9A,24VDC/3A.
- Thermal cut off.
- Short-circuit protection.
- High efficiency DC/DC converter.
- LED indicators for power input indication.
- Plug-and-Play.

Specification

Mode	POE-SP02BT-POE
Ports	1 10/100/1000M RJ45 PoE Port (DATA + POWER IN) 1 10/100/1000M RJ45 PoE Port (DATA + POWER OUT) 1 DC interface (DC OUT)
Network Media	10Mbps: Cat 3,4,5 Unshielded Cable 100Mbps: Cat 5,5E Unshielded Cable 1000Mbps: Cat 5E, 6 Unshielded Cable
Pass Through Data Rates	10/100/1000 Mbps
Power Output	Adjustable 5VDC/14A max, 9VDC/7.8A max, 12VDC/5.9A max, 24VDC/3A max
Input Power Requirements	DC Input Voltage: 44 to 57 VDC
Indicators	PoE Indicators / DC out Voltage Indicators
Connectors	Shielded RJ-45, EIA 568A and 568B
Dimensions	4.69 × 3.37 × 1.1" (119 × 85.5 × 28mm)
Environmental Conditions	Operating Ambient Temperature: -40°F to 167°F (-40 to 75°C) Operating Humidity: Maximum 90%, Non-condensing Storage Temperature: -40°F to 167°F (-40 to 75°C) Storage Humidity: Maximum 95%, Non-condensing
Regulatory Compliance	IEEE 802.3af (PoE) IEEE 802.3at (PoE) IEEE 802.3bt (PoE) IEEE 802.3 (Ethernet) IEEE 802.3u (Fast Ethernet) IEEE 802.3ab (Gigabit Ethernet) RoHS Compliant, CE, FCC
Electromagnetic	FCC Part15, Class B

Package Include



POE-SP02BT-POE



Terminal



DIN-Rail
Mounting Accessory



User Manual

Interface

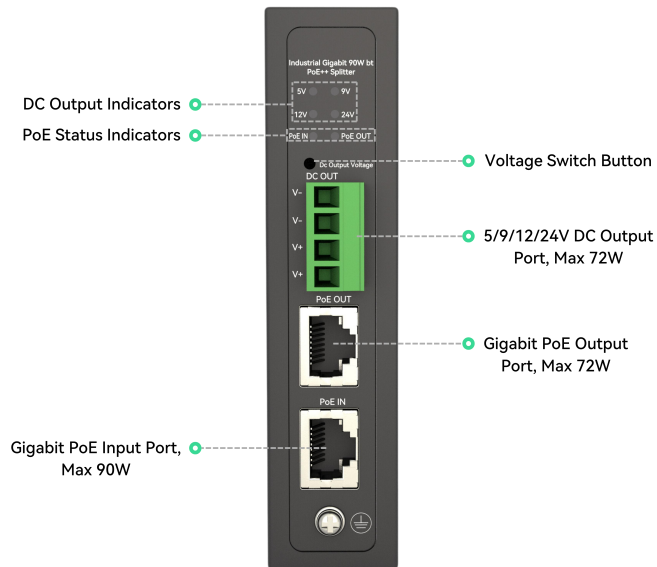

Application

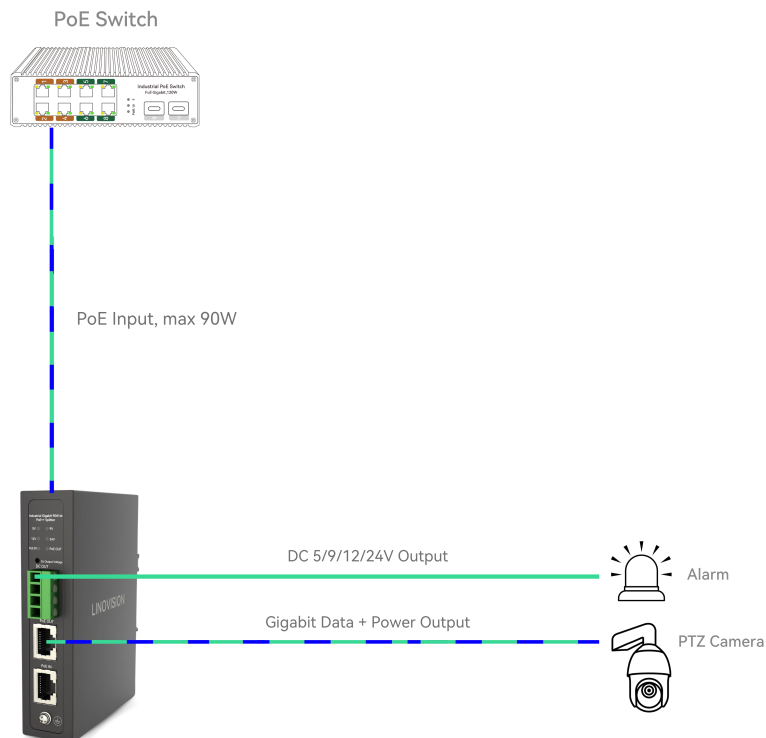

⚠ When using DC out port to power a PoE device, do not connect the PoE out port to this PoE device.

Dimension



Weight: 0.4kg (0.9 lb)

Installation

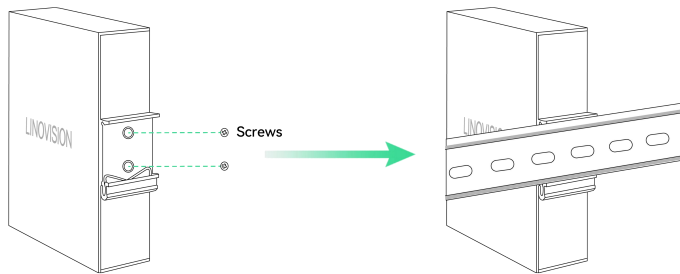

DIN-Rail Mounting

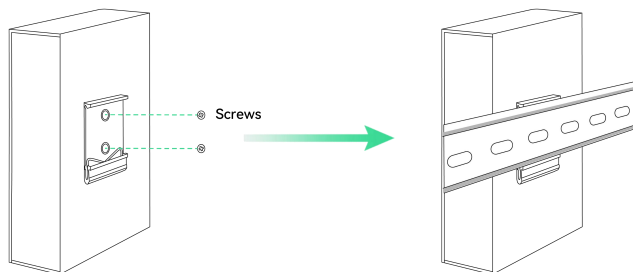

**Disclaimer: Technical specifications may subject to change without prior notice*