

POE-SWF508G4P2F

Industrial 8 Ports Wall Mount Flat Switch with 4 PoE Ports



Outstanding Features

- **4 Ports Full Gigabit PoE Switch:** Provides 4x IEEE802.3af/at PoE, 4x Gigabit uplink and 2 x Gigabit SFP Slot; Total POE budget 120W.
- **IEEE802.3af/at Compliant:** Providing up to 30W per port and total PoE power budget of 120W. Compatible with Mode A POE outputs only. PoE Pins 1/2(+), 3/6(-)
- **Dual DC Power Ports with Power Pass-Through Design:** Allows DC 48–56V power input on either port and provides pass-through power output to external devices. Simplifies wiring and reduces the need for additional power supplies in industrial, roadside, and distributed network deployments.
- **UL Listed 65W Power Included:** Optional 120W Power adapter PWR-48V25A.
- **Industrial Front-access Port Design:** Ultra-slim, wall-mountable flat switch with front-access ports, purpose-built for shallow cabinets and tight installation spaces, perfect for tight spaces like electrical cabinets, control boxes, or outdoor enclosures.
- **Surge Protection:** 6KV surge protection, keep the PoE devices from lightning strikes and other electrical surges, offering reliable performance even in some harsh environments. Wide operating temperature -30°C to 75°C (-22°F to 167°F).
- **Easy to use:** Plug and play, no configuration is needed. Support DIN-Rail & Wall Mount; compact dimension 178 * 134 * 24.5 mm (7.01 * 5.28 * 0.96 in).

Specification

Hardware	
Connector	8 * 10/100/1000Base-TRJ45 2 * 1000 Base-X SFP
PoE Port	4 * 10/100/1000 Mbps RJ45 PoE+ Ports
LED indicators	Power Indicator: Green (PWR) Network Indicator: Green (Link) PoE Indicator: Yellow (PoE) SFP Indicator: Green (SFP1/2)
Network standard	IEEE802.3i 10 BASE-T IEEE802.3u 100 BASE-TX IEEE802.3ab/z 1000 BASE-TX IEEE802.3x Flow Control
Backplane bandwidth	24 Gbps
Packet forwarding rate	14.88 Mpps
MAC address	4K
Power requirement	DC 48-56 V
ESD Protection	6 KV ESD protection
Dimension	178 * 134 * 24.5 mm (7.01 * 5.28 * 0.96 in)
Weight	0.7 kg (1.54 lb)
PoE	
PoE Standard	IEEE 802.3af / IEEE 802.3at (PSE)
PoE Supply Type	1/2(+), 3/6(-) (End-span)
PoE Power Output	Max. 15.4 W (IEEE 802.3af) Max. 30 W (IEEE 802.3at)
PoE Power budget	Max. 120 W (default power supply supports up to 65 W)
Environment	
Operating temperature	-30°C ~ 75°C (-22°F ~ 167°F)
Storage temperature	-40°C ~ 85°C (-40°F ~ 185°F)
Operating humidity	5%~95%
Storage humidity	5%~95%
Safety	FCC Part15 Class A, CE, RoHs

**Disclaimer: Technical specifications may subject to change without prior notice*

Interface

Front View

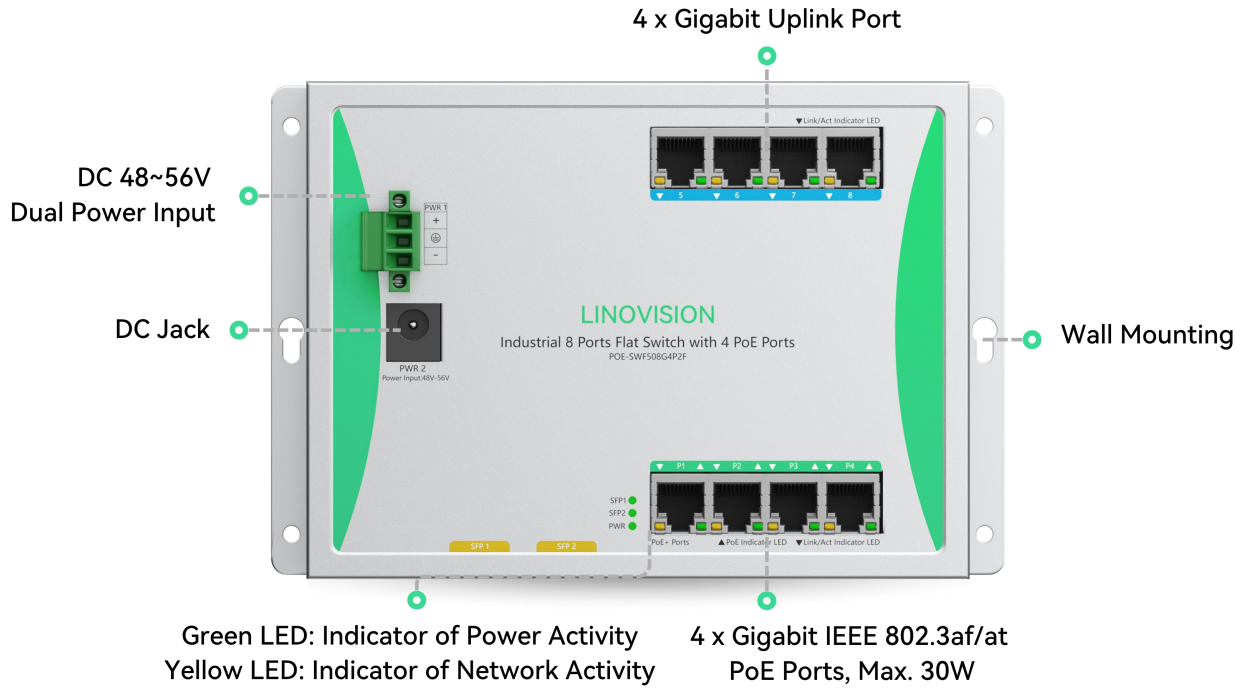

Side View

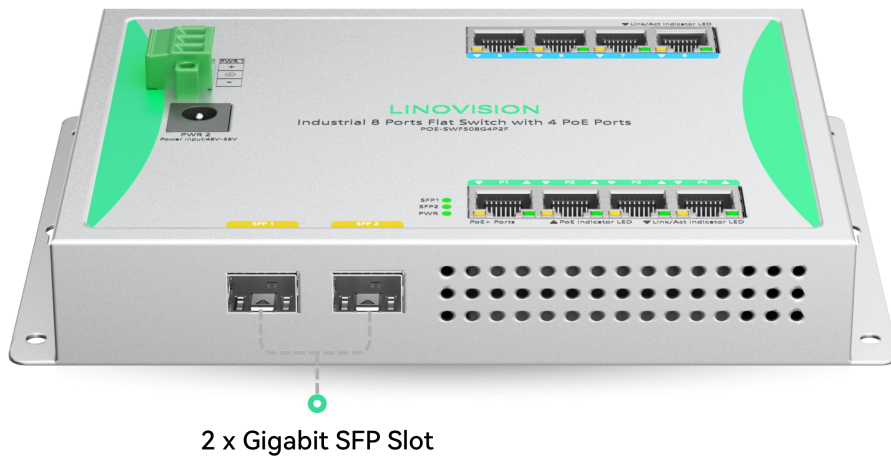

**Disclaimer: Technical specifications may subject to change without prior notice*

Connection Diagram

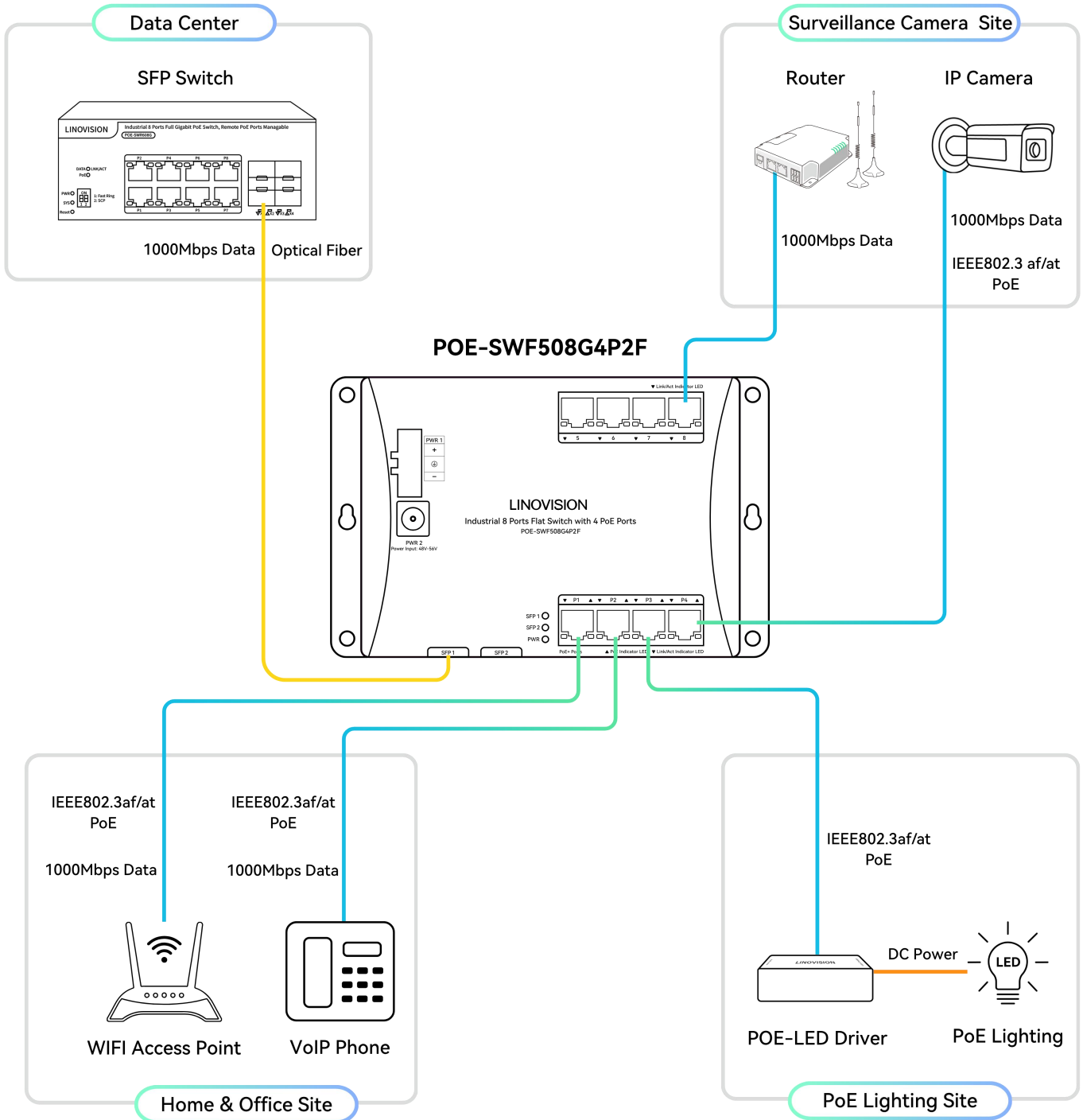

**Disclaimer: Technical specifications may subject to change without prior notice*

Dimension

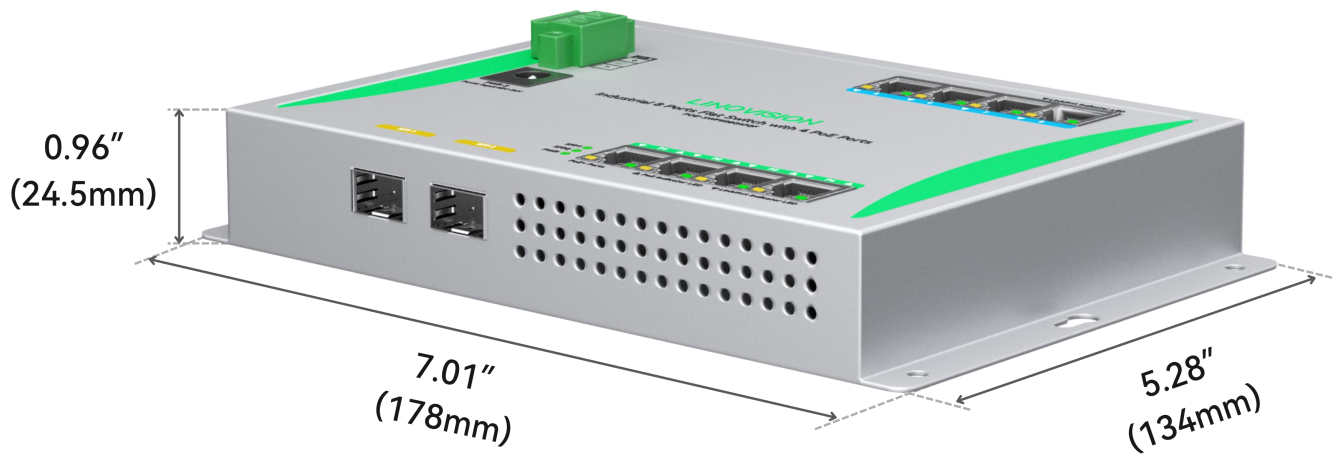

Weight: 700g (1.54 lb)

Installation

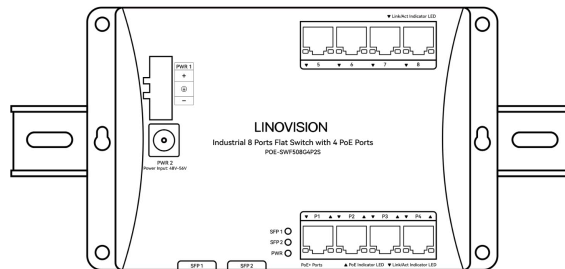
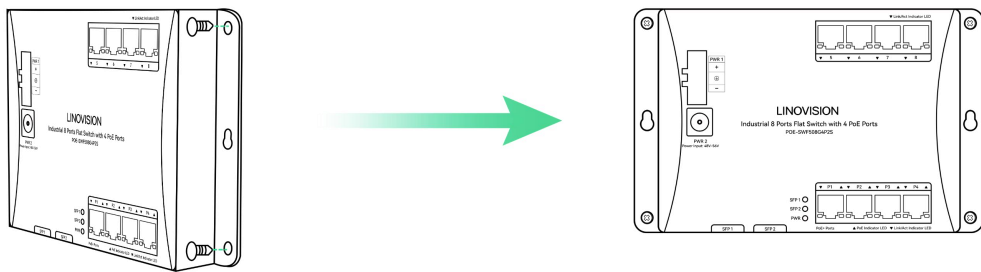

DIN-rail Installation & Wall Mounting

Package

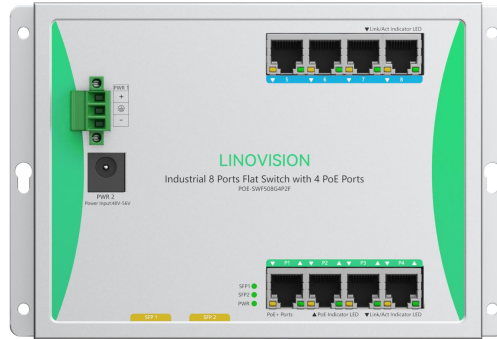

POE-SWF508G4P2F



UL Listed
AC 110~240V to DC 48V 1.35A
Power Adapter



POE-
SWF508G4P2F

Quick Guide