

LINOVISION

Industrial 8 Ports Flat Switch
POE-SWF508G4P2F
Quick Guide (V1.0/2026-1-20)



Quick Guide

Package Contents

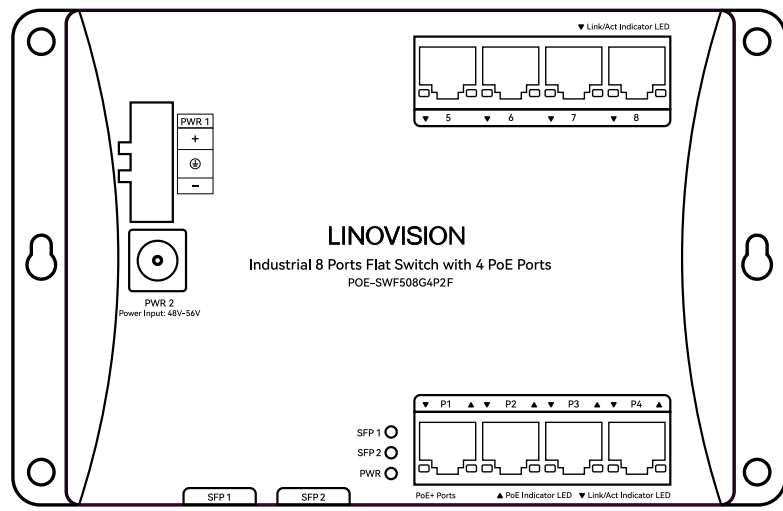

POE-SWF508G4P2F

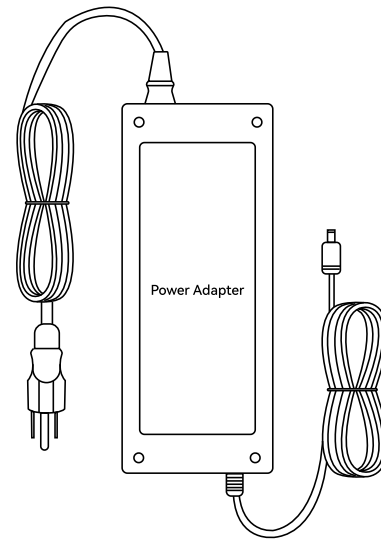

Power Adapter



Quick Guide

Interface

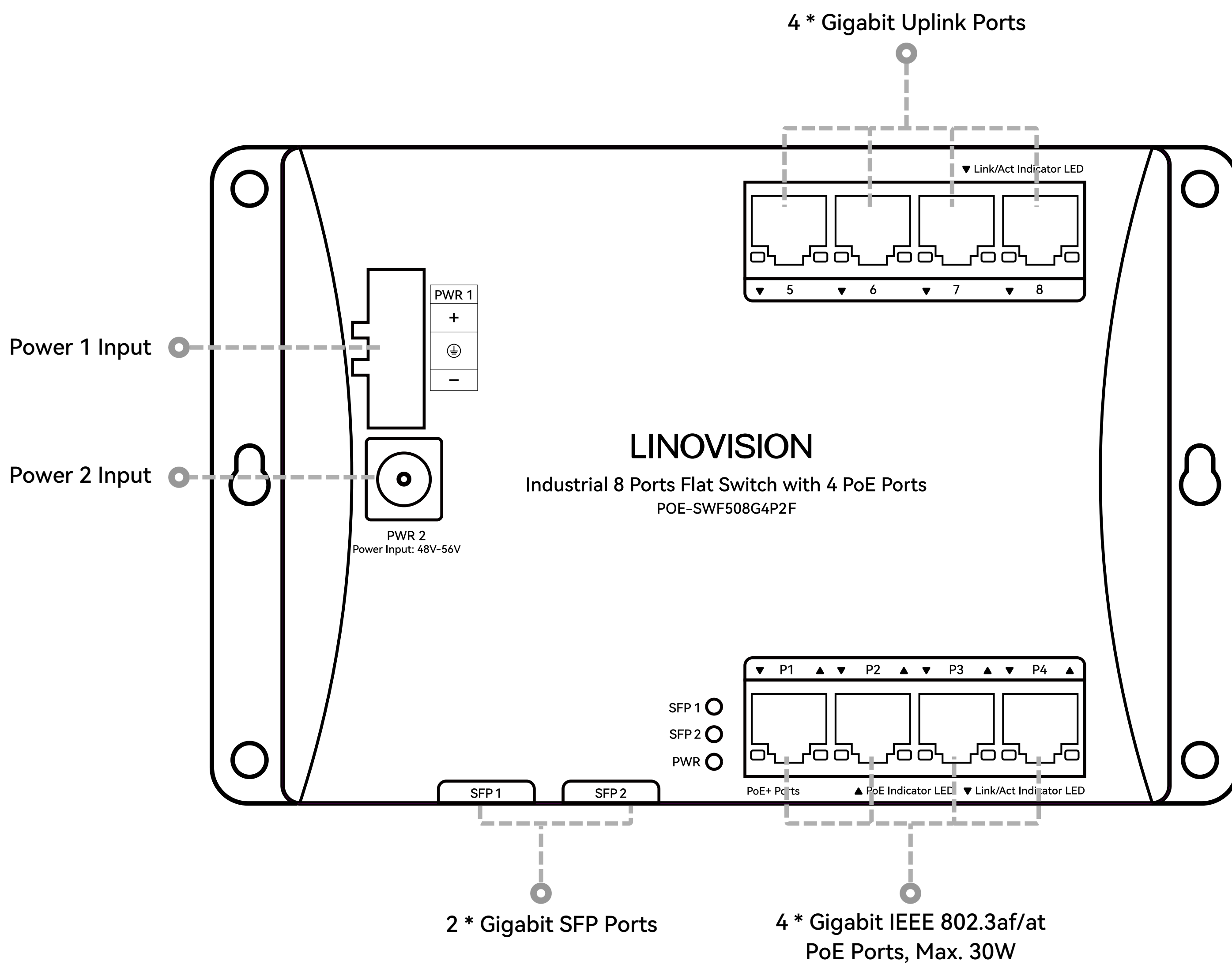

4 * Gigabit Uplink Ports

Power 1 Input

Power 2 Input

2 * Gigabit SFP Ports

4 * Gigabit IEEE 802.3af/at
PoE Ports, Max. 30W

Installation

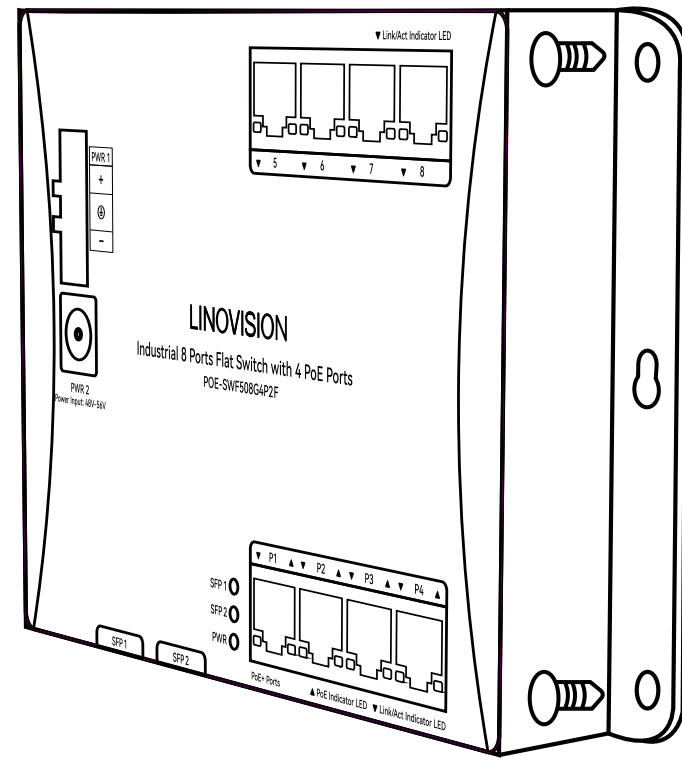

Wall-mounted Installation

Connection Diagram

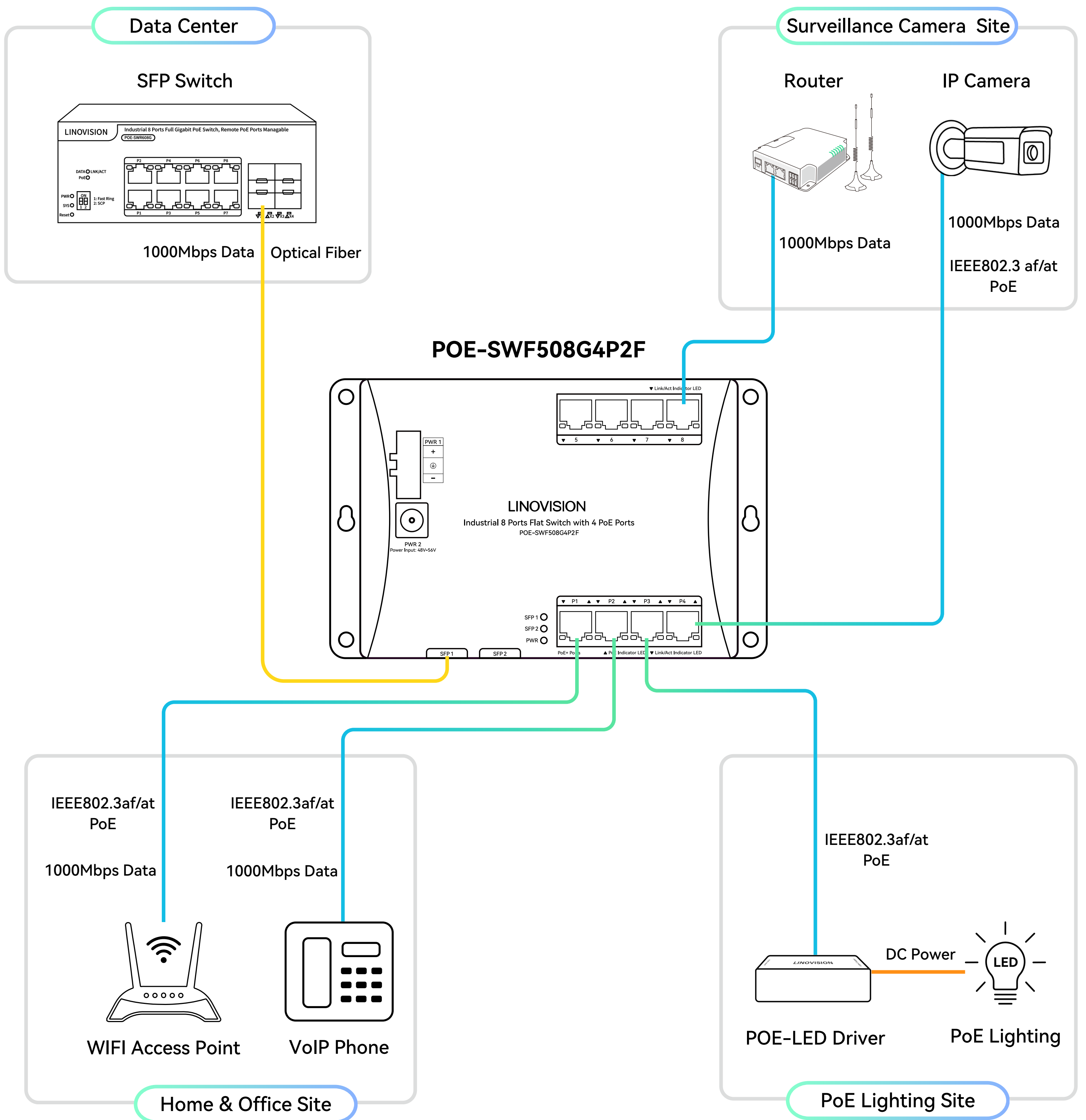

LED Indicator

Indicator	Colour	LED Status	Working Status
Power	Green	On	Power input normal
		Off	Power abnormal or no power supply
Link/Act	Yellow	On	Link normal
		Blink	Data is being transmitted
		Off	Link abnormal
PoE	Yellow	On	PoE normal
		Off	PoE abnormal
SFP	Green	On	Fiber link normal
		Off	Fiber link abnormal

Data Sheet

Hardware	
Connector	8 * 10/100/1000Base-TRJ45 2 * 1000 Base-X SFP
PoE Port	4 * 10/100/1000 Mbps RJ45 PoE+ Ports
LED indicators	Power Indicator: Green (PWR) Network Indicator: Green (Link) PoE Indicator: Yellow (PoE) SFP Indicator: Green (SFP1/2)
Network standard	IEEE802.3i 10 BASE-T IEEE802.3u 100 BASE-TX IEEE802.3ab/z 1000 BASE-TX IEEE802.3x Flow Control
Backplane bandwidth	24 Gbps
Packet forwarding rate	14.88 Mpps
MAC address	4K
Power requirement	DC 48-56 V
ESD Protection	6 KV ESD protection
Dimension	178 * 134 * 24.5 mm (7.01 * 5.28 * 0.96 in)
Weight	0.7 kg (1.54 lb)

PoE	
PoE Standard	IEEE 802.3af / IEEE 802.3at (PSE)
PoE Supply Type	1/2(+), 3/6(-) (End-span)
PoE Power Output	Max. 15.4 W (IEEE 802.3af) Max. 30 W (IEEE 802.3at)
PoE Power budget	Max. 120 W (default power supply supports up to 65 W)
Environment	
Operating temperature	-30°C ~ 75°C (-22°F ~ 167°F)
Storage temperature	-40°C ~ 85°C (-40°F ~ 185°F)
Operating humidity	5%~95%
Storage humidity	5%~95%
Safety	FCC Part15 Class A, CE, RoHs