

LINOVISION

Industrial 8 Ports Remote Solar PoE Switch POE-SWR608G-Solar Quick Guide (V1.2/2026-5-8)



Quick Guide

Package Contents



POE-SWR608G-SOLAR



Terminal

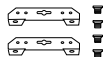

Wall Mount Accessory



Din Rail Mount Accessory



Quick Guide

Installation

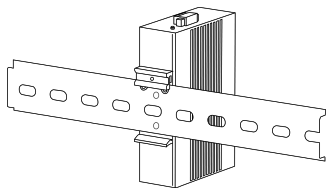
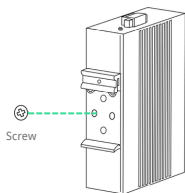

Din Rail Mount

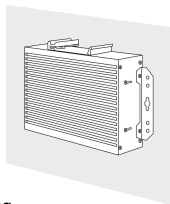
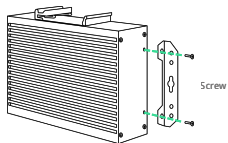

Wall Mounting

Interface

Front View

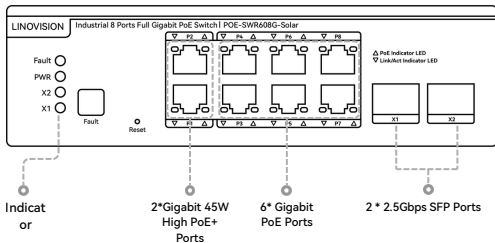

Side View

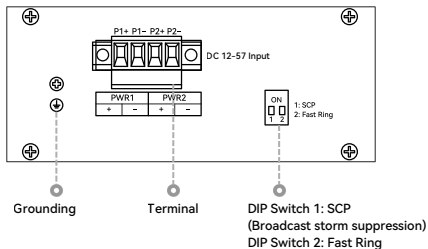

Application

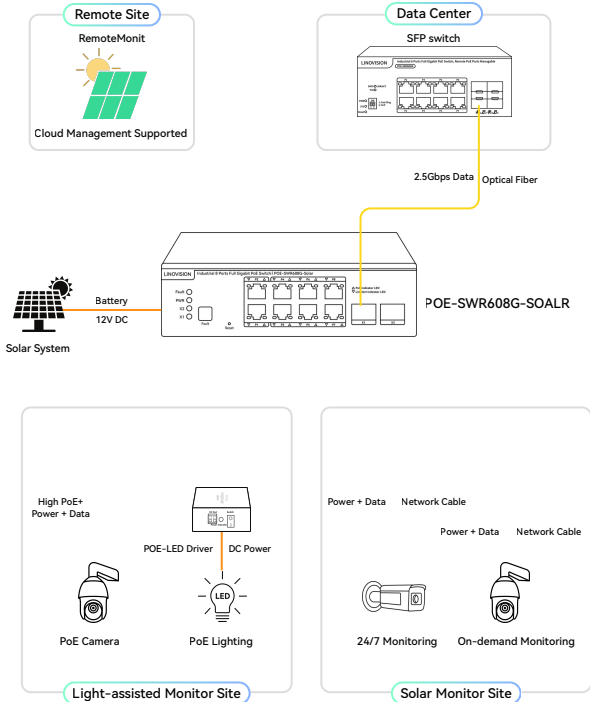

Data Sheet

Interface	8×10/100/1000Mbps RJ45 Ports 2×2.5Gbps SFP Ports
Standard	IEEE802.3, IEEE802.3u, IEEE802.3ab, IEEE802.3z, IEEE802.3x, IEEE802.1x, IEEE802.1q, IEEE802.1p, IEEE802.1d, IEEE802.1w, IEEE802.3ad, IEEE802.3af, IEEE802.3at
Network Media (Cable)	10BASE-T: UTP category 3,4,5 cable (≤100 m)100BASE-TX: UTP category 5,5e cable (≤100 m)1000BASE-X: UTP category 5e,6 cable (≤100 m)1000BASE-X: MMF, SMF
PoE Standard	IEEE802.3af/at
PoE port	Port1-8
PoE Output	Port 1-2: 45W (Max) Port 3-8: 30W (Max)
PoE Power On RJ45	1/2 (+), 3/6 (-)
PoE Power Budget	70W @ 12V 180W @ 24V/48V
Total power supply (reference)	200W
Input voltage	DC 12-57V
MAC Address Table	16K, Auto-learning, Auto-update
Jumbo Frame	12KByte
Buffer	8.4Mbit
Transfer Mode	Store-and-forward
Packet Forward Speed	19.34Mbps
Switching Capacity	26Gbps
Dimensions (L×W×H)	163×110×46mm (6.42"×4.3"×1.81")
Operating Temperature	-20°C ~ 60°C (-4°F ~ 140°F)
Storage Temperature	-40°C ~ 80°C (-40°F ~ 176°F)
Operating Humidity	10% ~ 90% non-condensing
Storage Humidity	5% ~ 90% non-condensing
Surge Protection	Differential mode ±2 KV, Common mode ±4 KV
Electrostatic Standard	Contact ±6 KV, Air ±8 KV

Data Sheet

Function menu	Functional description	Added
Function menu	Login authentication and logout	
	Bilingual (Chinese-English Switching)	
	Port Panel (two colors distinguish speed)	1000M green 100M/10M orange-yellow
System Settings	Device Info	Hostname / Device Contact / Device Location
	IP Settings	Static / DHCP Client / DNS
	Web Settings	Web timeout settings
	Telnet Settings	Support telnet enabled/disabled Support telnet timeout setting
	User Management	Password must contain at least letters & numbers, length ≥ 6
	Upgrade	Local Upgrade
	Device Management	Reboot / Save Configure / Restore
Monitoring	Port Statistics	Reboot / Save Configure / Restore
	Cable Diagnostics	Reboot / Save Configure / Restore
	Loop Guard	rloop
	IGMP Snooping	Flood/Drop / DIP Mode
Switch Settings	Port Settings	Status Speed / Duplex / Flow Control
	Port Mirroring	In/Out/All
	Port Isolation	
	Jumbo Frame	Support 1522-10000 Bytes
	Green Enable	
	Static MAC	
	Filter MAC	
	Search MAC	
	MAC List	Classified display static/dynamic MAC address
DHCP Snooping		
Switch Settings	VLAN Member	
	VLAN Settings	Access, Trunk
QoS Settings	Port Rate	
	Storm Control	

Data Sheet

Function menu	Functional description	Added
QoS Settings	QoS Priority Mapping	Support CoS and DSCP priority mapping
	QoS Queue Scheduling	Support 8 queue, SP and WRR Queue Scheduling
PoE Settings	PoE Basic Settings	Support enabled/disabled PoE port Force Power PoE Port Limit PD Alive
Cloud Settings	Cloud Settings	MQTT

LED Indicator

LED	Color	Function
PWR	Green	Off: No Power supply.
		Light: Indicates the Switch has power.
LNK/ACT	Green	Off: No connected device.
		Light: Connect to a network device.
		Blinking: Data is being transferred.
POE	Orange	Out: The port does not supply power to the opposing device.
		Light: there are electric equipment connected to it, and normal.

Configuration

- 1 Connect the POE-SWR608G-SOLAR to a power source, and use an RJ45 cable to connect it to your computer.
- 2 Open your network connections and modify the settings for the network interface corresponding to the POE-SWR608G-SOLAR. Set the IP configuration to manual and assign the IP address to '192.168.2.2'.
- 3 Open your browser and navigate to the default IP address of the POE-SWR608G-SOLAR, "192.168.2.1", and log in with the default username "admin" and password "admin".
- 4 On the sidebar, select "System Settings" - "IP Settings". Set "Auto Obtain IP" to "Enable" and click "Apply" to apply the settings.

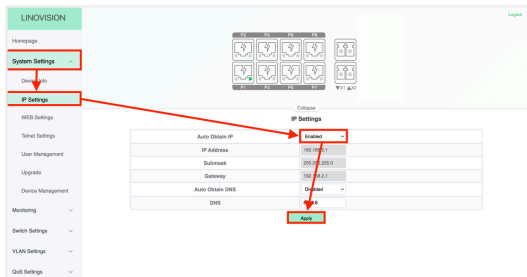

- 5 Connect the POE-SWR608G-SOLAR to the router/gateway with RJ45 cable. Consult your network administrator or go to the router's configuration page to obtain the new IP address of the POE-SWR608G-SOLAR.
- 6 Save all your settings in the top right corner of the web page.